

DEEP BLUE

DEEP BLUE



AllYachtsWorldwide.com



WELCOME ABOARD...



The 43.7m (143'4") DEEP BLUE is the success story of a yacht that combines quality construction with a detailed and thoughtful design that considers every aspect of life on board, from the domain of the owner and his guests to that of the crew and their working areas.

Launched in Holland in 1996, and the result of a fruitful collaboration between Oceanco, Monaco based naval architects The "A" Group and interior designer Donald Starkey, this fully ocean-going vessel has a range of 2,800 nautical miles and can achieve a top speed of about 19 knots. Completely refitted in year 2007, with interior design by Paolo Rossi. DEEP BLUE's superior design and construction was internationally recognized when, few years ago, she won the Showboats International Award for the Best Semi-Displacement Yacht of over 40m.

DEEP BLUE



DEEP BLUE's clean profile and well proportioned lines cut a striking figure under way. Particularly doted with ample deck space, the yacht's sun deck with Jacuzzi and extensive sunpads provides the perfect setting for relaxation. Forward of the Jacuzzi, the sun deck also offers the owner and guests the opportunity to dine casually around a table beneath an optional awning.



SUNDECK & JACUZZI





AllYachtsWorldwide.com

The huge expanse of the upper aft deck unites with the upper lounge to create a true indoor-outdoor living area, where dining al fresco up to twelve guests, professional DJ station (located inside the lounge) and comfortable lounging are all on offer.



Type of ship	Motor Yacht
Builder	De Waal Shipyards by Netherlands
Hull Number	Y 232
Interior Designer	Don Starkey / Fabro
Naval Architect	The "A" Group Monaco
Length Over All	43.80 meters
Length Water Line	37.50 meters
Beam Over All	8.50 meters
Beam Extreme	8.80 meters
Depth	4.06 meters

Hull Structure	Aluminium
S/Structure	Aluminium

Date of Delivery	May 1996
Date last Major Refit	May 2006

Gross Tonnage	440 register tons
Net Tonnage	132 register tons
Displacement	275 metric tons

Total Fuel Capacity	53000 liters
Total Water Capacity	20800 liters

Number of passenger	10
Number of Crew	10

Main Engines & Technical equipment

Engine Type	2 x MTU 12V 396 TE 94
Total Maximum Output	3360 kW (4500 Hp (2 x 2250Hp each))
Number of Cylinders	12
Diameter of Cylinders	165mm
Length of Strokes	185mm
No 2 Propellers	Shaftran, Class ISO TBCR484 I-S, material G- NIALB 28

Bow thruster (Cramm)	75 kw
Maximum Speed	19 Knots
Cruising Speed	15 Knots
Average Consumption	450 lt @ 1500rpm (15 knots)

Range	2800 nautical miles
-------	---------------------

Generators	Ship's Electrical Power
	220/380V 50 Hz

Engine Type	2 x Northern Lights
Model	M6108T/HE/99L

Total Maximum Output	99 Kw
----------------------	-------

Phase	3
Amps	188 A

Stabilizers at Anchor	Quantum QC-1200E Custom
	Zero - Speed

Power Unit	QP20.20
Fin size:	2.25msq

Watermakers:	2 x Idromar @ 5,500 lt per day = 11 000 lt total
--------------	--

Sounder Transducers	Furuno: 20 cm above Keel
	Dataline 24 cm above Keel
	Doppler 21 cm above Keel

Electronic Equipments

No 2 Radar ARPA	Furuno FAR 2827
Cartographic System	Transas Navi Sailor 3000 RCDIS-I
	Version 4.00.01
Ecosounder	Furuno FE 700
AIS GPS	MX 420
GPS	SIMRAD CP33
Doppler Speed Log	Furuno DS 80
Wind Meter	B&G Hydra 2000
VHF	3 x Sailor Compact RT 2048
SSB	Sailor RE 2100
Navitex	Furuno NX 500
Inmarsat Mini -C	Felcom 16
Internet	Seatel 4006
Sat Television	Seatel 4004

All speeds, measurements, capacities, consumptions, etc. may be approximate or estimated. Specifications provided for information only.
Design & Printing by Studio Deer Paris - Photography: B. Black & M. Paris
Special thanks to the Captain and crew for their precious help, their kind hospitality and their professionalism.

01 - JACUZZI

02-- SUN MATRESSES

03- WET BAR

04 - UPPER AFT DECK

05 - UPPER LOUNGE & BAR

06 - UPPER DAY HEAD

07 - CAPTAIN's CABIN

08 - BRIDGE

09 - SWIMMING PLATFORM

10 - MAIN AFT DECK

11 - MAIN SALON

12 - DINING ROOM & MEETING

13 - GALLEY

14 - MASTER STATEROOM

15 - MASTER STUDY

16 - HIS BATHROOM

17 - HER BATHROOM

18 - QUEEN STATEROOM

19 - TWIN STATEROOM

20 - VIP STATEROOM

21 - MEDIA ROOM or KIDS' ROOM

22 - CREW QUARTERS

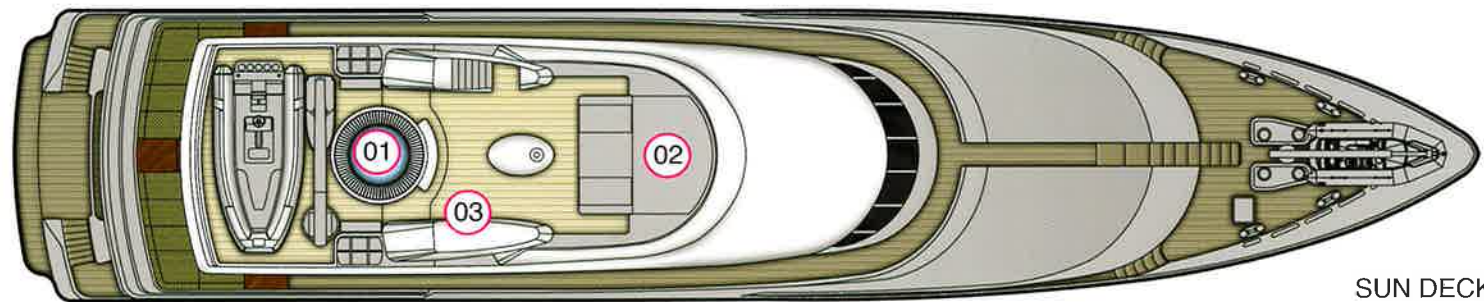

SUN DECK

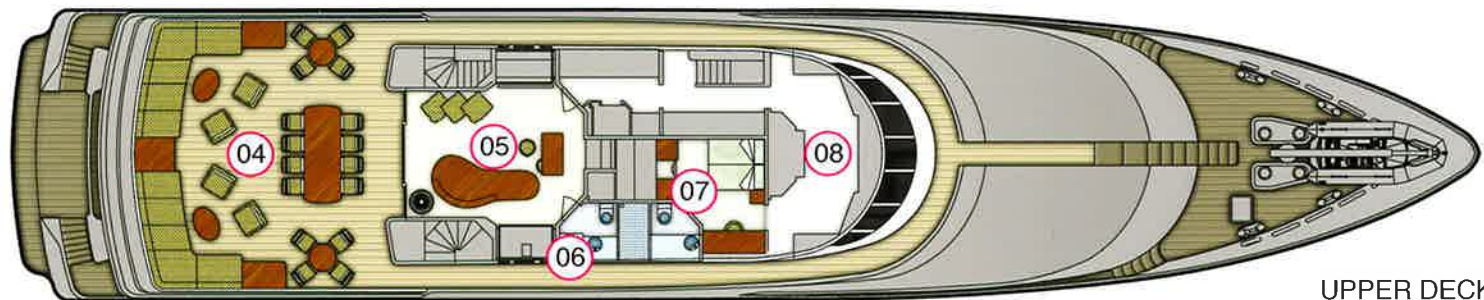

UPPER DECK

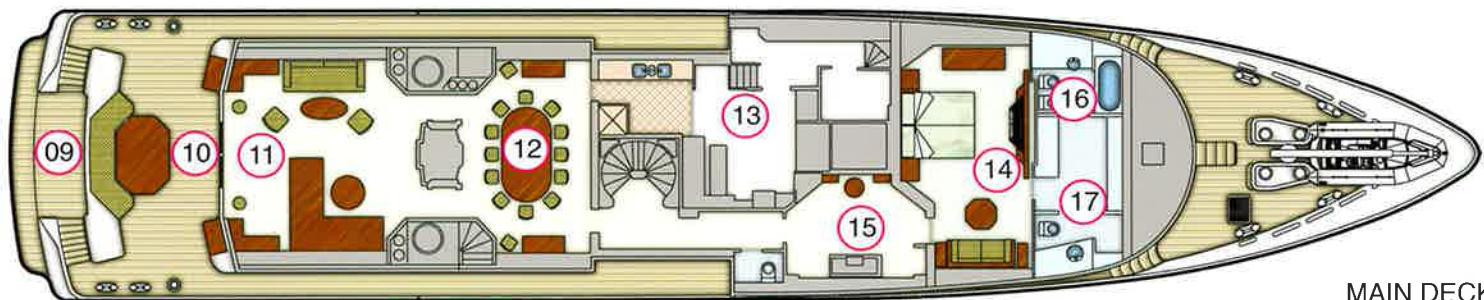

MAIN DECK

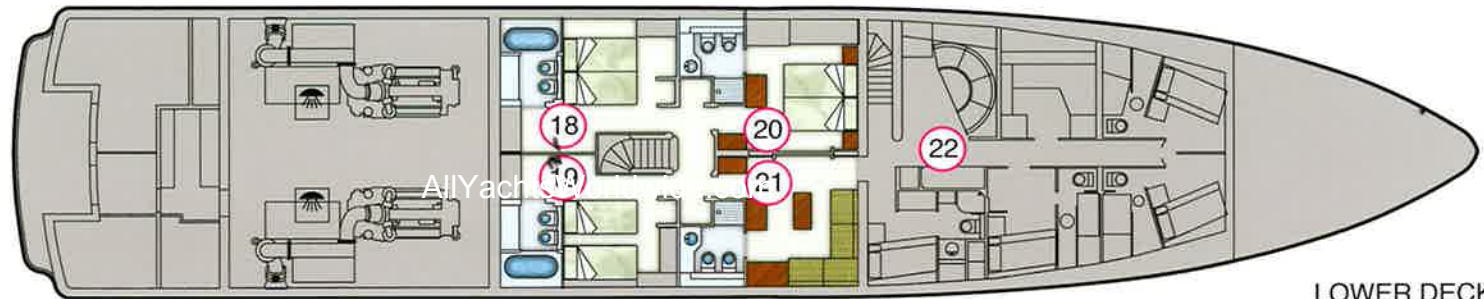

LOWER DECK



AllYachtsWorldwide.com