







Sun Deck



Sun Deck



Sun Deck - Dinning



Sun Deck - Hammock



Sun Deck



Bridge Deck



Bridge Deck



Upper Deck - Lounge



Upper Deck - Lounge



Upper Deck - Dining



Main Deck - Lounge



Main Deck - Lounge



Main Deck



Retractable Platform



VIP Saloon



Main Saloon



Dinning Room



Dinning Room



Cinema



Massage Room / Beauty Salon



Staircase



Master Suite



Master Suite



Master Suite Bathroom



Executive Suite



VIP Suite



VIP Suite Bathroom



VIP Suite



VIP Suite



VIP Suite



Guest Suite



Guest Suite



Guest Suite



Guest Suite



Guest Suite Bathroom



Water Toys



Water Toys



Tender

CORPORATE EVENTS & UNIQUE CELEBRATIONS
ALWAYS IN PURE LUXURY AND

style



[A Cannes Film Festival](#)



[A Corporate events](#)



[A Birthday & wedding parties](#)



[A Grand Prix de Monaco](#) [▶](#)



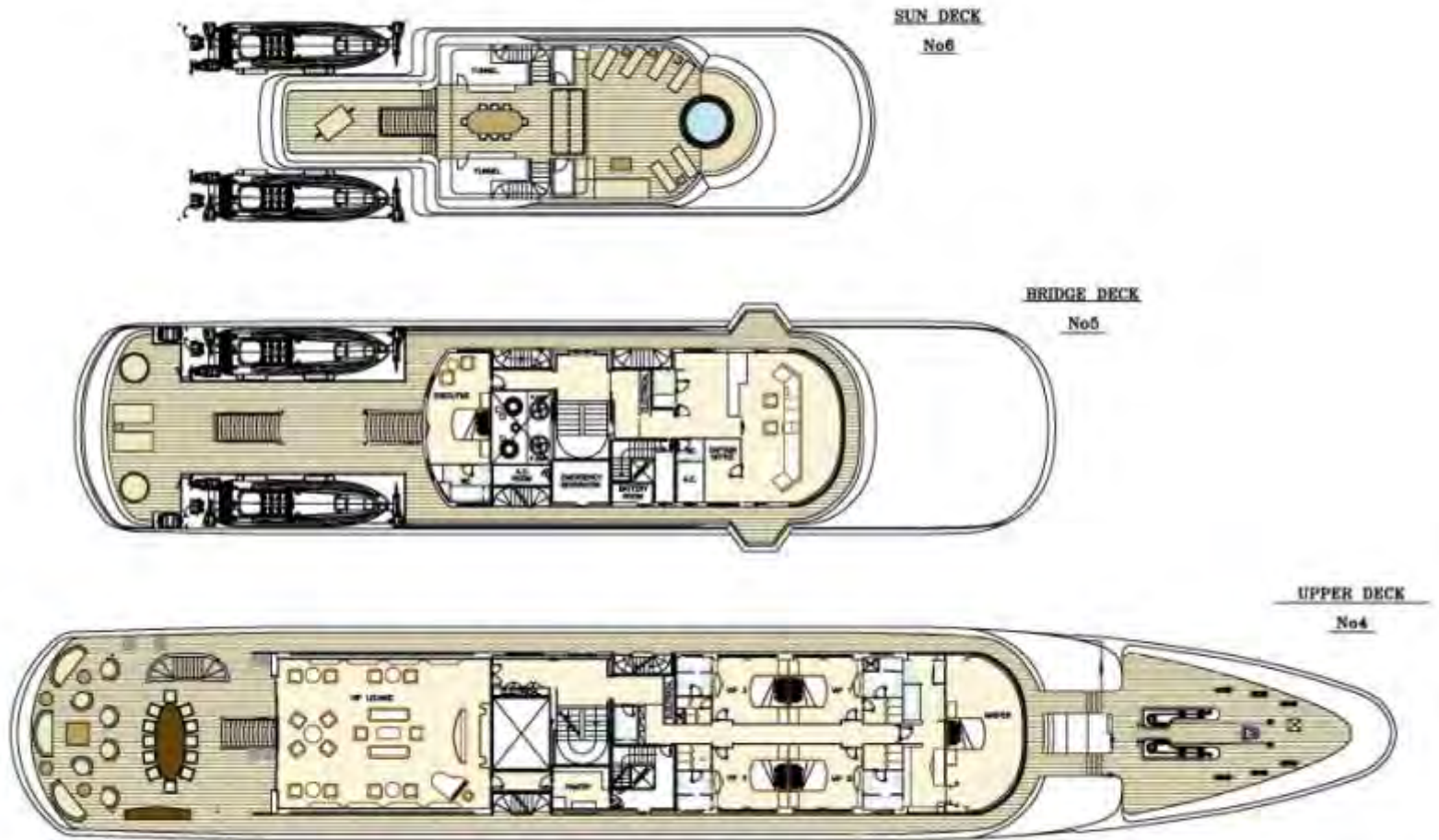

General Arrangement

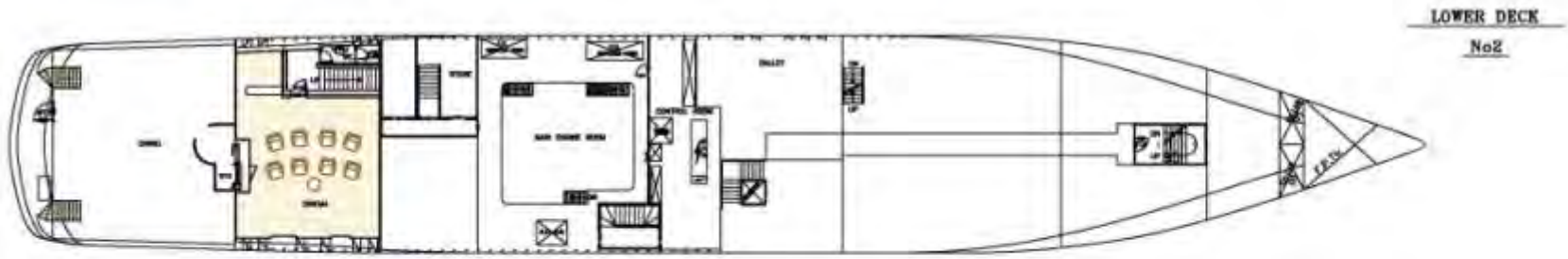

General Arrangement

<p>Specifications</p> <p>Builder: Mitsubishi Heavy Industries Co. Ltd. Rebuild Date: 2004 Refit: 2009 and 2011 Flag: Greek Classification: Bureau Veritas Length: 82.50 meters (271 ft) Beam: 11.60 meters (38.05 ft) Draft: 4.40 meters (14.43 ft) Construction: Steel/Aluminium Designer: Giorgio Vafiadis & Associates Displacement: 1975 tons Speed: 13 knots cruising / 15 knots maximum Main Engines: 2 Yanmar x 2000/650 (BHP/RPM) Generators: 3 X Volvo Penta D16C-AMG1800 RPM Main Engine Fuel consumption: 790 lt/hr Generators Fuel consumption: 2500 lt/day Stabilisers: Rolls Royce (retractable) Zero Speed Guests: 30 Crew: 30</p> <p>Accommodation</p> <p>30 Guests in: 1 Master stateroom 1 Executive stateroom 4 Double VIP suites 5 Double guest cabin 4 Twin guest cabins</p> <p>Communication</p> <p>High Speed Wireless Internet through VSAT broadband service, Inmarsat C, Inmarsat F77, VHF-DSC, GMDSS, Navtex Receiver.</p> <p>Navigation</p> <p>Integrated Navigation System Sperry Marine, Visionmaster FT S-Band Radar, Visionmaster X-Band Radar, SAAB AIS Transponder, Sperry Marine ECDIS Electronic Charts System, Flir Night Vision.</p>	<p>Watersports</p> <p>2 x 9.2 meters Fassmer Enclosed Life Boats / Limousine Tenders with Air Conditioning, Audio equipment and Leather Upholstery for 22 guests. 1 x Custom 6m RIB for 7 Guests 1 x Jet Ski Sea Doo GTX 260 limited 3 Guests 1 x Jet Ski Sea Doo RXP-X 260 2 Guests 1 x Jet Ski Kawasaki ZXI 900 2 Guests 2 x Seabobs Cayago Luxury Sea-toy Floating Trampoline 2 x Sea Kayaks Water Skis (Mono/Double/Children's) Tows 2 x Nuclear Globes Wakeboards Snorkeling equipment Scuba Gear (4 sets) and Compressor</p> <p>Other</p> <p>Cinema room with 65 inch screen seating 8 guests in La-Z-Boy armchairs Piano in VIP Salon Wii/Playstation 3 + Games CD/DVD library Plasma screens throughout Dolby stereo surround sound + DVD + CD in all cabins Retractable Swimming Platform Jacuzzi Beauty Salon/ Massage room Beautician/Masseuse on board</p> <p>Gym equipment</p> <p>1 x Bike –Technogym 2 x Reclining Bikes – Technogym/Life Fitness 2 x Elliptical - Amila / Precor Weights 2kg - 50kg</p>
--	--

Specifications